



# WELCOME TO GARDENIA



There is nothing quite as joyful as the luxury of space and nothing gives you as much peace as living in the lap of nature. At Gardenia luxury ville, Adoni you will reveal in these pleasures day after day for the lifetime to come. Thoughtfully planned to delight you with sprawling area and a host of amenities, Gardenia is just what you would be waiting all these years.





METI  
DEVELOPERS

  
**GARDENIA**  
*luxury villas*

  
**GARDENIA**  
*luxury villas*

ENTER  
A NEW ERA,  
A NEW WORLD .....



EAST FACING VILLA - EVENING VIEW

## PROJECT HIGHLIGHTS

- Designer Landscaping in Parks
- Children play Area
- Wide 40' Driveways
- 24 hr security with intercom
- Surveillance Cameras
- Controlled Entry and Exit

## PROJECT HIGHLIGHTS

- A Gated community of 4.21 acres
- KUDA approved Project
- 60 Duplex Villas
- East and West Facing Villas
- Vastu Compliant
- Exclusive Club House



WEST FACING VILLA - EVENING VIEW





## **CLUB HOUSE**

**MULTIFUNCTIONAL HALL**

**INDOOR GAMES**

**GYM**

**SWIMMING POOL**

**DECK AREA**

**YOGA ROOM**

# EAST FACING VILLA

33'X40'



## GROUND FLOOR PLAN



## FIRST FLOOR PLAN

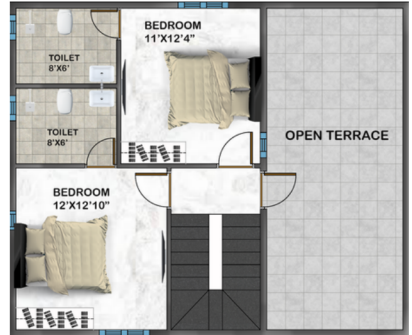

## AREA STATEMENT

PLOT AREA	- 33'X40' -1320 SQFT -3.03 CENTS
GROUND FLOOR AREA	- 905 SQFT
FIRST FLOOR AREA	- 541 SQFT
TOTAL BUILT UP AREA	- 1446 SQFT

# WEST FACING VILLA

33'X40'



## GROUND FLOOR PLAN

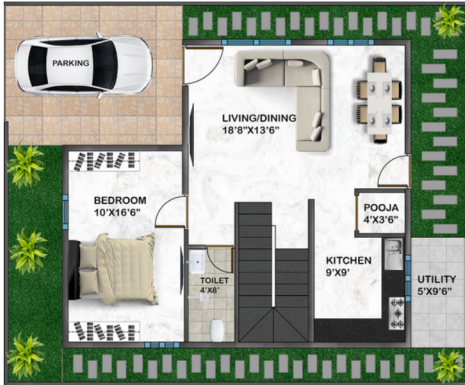

## FIRST FLOOR PLAN



## AREA STATEMENT

PLOT AREA	- 33'X40' -1320 SQFT -3.03 CENTS
GROUND FLOOR AREA	- 874 SQFT
FIRST FLOOR AREA	- 607 SQFT
TOTAL BUILT UP AREA	- 1481 SQFT



# BEAUTY IS IN THE DETAILS.

ALL THE  
SPECIFICATIONS YOU  
NEED TO KNOW.



## WALLS AND PLASTERING

- RCC framed structure with solid blocks for walls masonry with cement mortar
- Internal walls with lime rendering smooth finish & external walls of sponge finish
- Open kitchen concept

## DOORS AND WINDOWS

- NCL dura doors or equivalent for Main door and Bedroom doors
- Sal wood door frame & flush door to bath rooms
- UPVC sliding windows with glass & security grills (Indian standard make)
- For all door & shutters, standard SS hardware fitting (hinges, latches & handles)

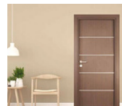

## ELECTRICAL

- Modular switches (Any standard make). Concealed fire resistant ISI standard quality copper wiring
- Provision for A/C in hall and all bedrooms' T.V. & Telephone point in living & all bedrooms

## FLOORING

- Granite flooring in corridors and stair case
- Standard make vitrified tiles in all rooms, living room, dining, kitchen and ceramic tiles for other areas



## PAINTING

- Plastic emulsion for internal walls
- External in weather coat paint
- Enamel paint for doors and grills
- Natural polish for main doors as per Architectural drawing

## KITCHEN

- 2 feet height tile dadoing for kitchen platform
- Black granite platform with SS sink with drain board
- In utility, Provision for washing machine and sink



## PLUMBING AND SANITARYWARE

- Concealed good quality PVC/CPVC/UPVC pipes
- All bathrooms feature best quality CP and sanitaryware fixtures- Jaquar or equivalent
- Provision for Geysers in all bathrooms and Kitchen

PLOT TYPE	SIZE	CENTS	SQFT	NO
A	33'X40'	3.03	1320	40
O1	43'1"X55'5"	6.57	2861	1
O2	33'X52'	3.94	1715	1
O3	33'X49'	3.71	1615	1
O4	33'X45'10"	3.48	1516	1
O5	33'X42'10"	3.25	1416	1
O6	33'X39'10"	3.02	1316	1
O7	33'X36'9"	2.79	1217	1
O8	66'X32'3"	4.90	2134	1
O9	61'9"X22'9"	3.24	1410	1
O10	37'2"X88'4"	7.26	3164	1
O11	33'X85'	6.44	2804	1
O12	51'X40'	5.80	2525	1
O13	59'3"X40'	5.45	2373	1
O14	43'5"X40'	4.43	1930	1
O15	66'6"X40'	4.99	2173	1
O16	33'X41'4"	3.13	1364	1
O17	33'X58'	4.40	1915	1
O18	40'X66'	5.64	2456	1
O19	33'4"X40'	3.05	1327	1
O20	55'10"X40'	5.45	2373	1
TOTAL				60



# SITE LOCATION

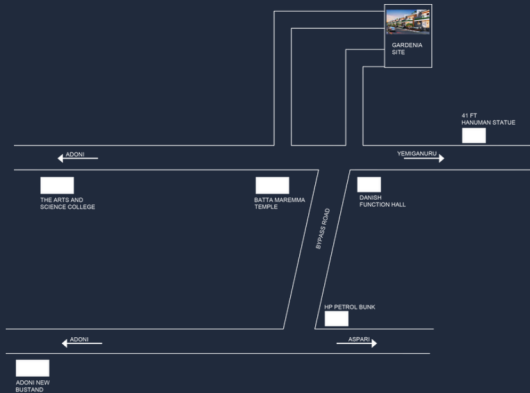

**METI  
DEVELOPERS**

BY



**RADIANT  
GROUP**

AN ISO 9000:2001 COMPANY

## CONTACT US

☎ 9848582448, 7019585140

✉ [metidevelopers@gmail.com](mailto:metidevelopers@gmail.com)

### SITE ADDRESS-

Opp to Bypass circle,  
Yemmiganuru Road,  
Adoni .



## ARCHITECTS AND STRUCTURAL CONSULTANTS



**SQUAD INFRATECH**  
Flat no 202,Radiant White  
Orchid, Kalenaagrahara,  
Bannerghatta Road,  
Bengaluru-560076.

Ph No - 8904221992.  
Email Id - [squadinfratech@gmail.com](mailto:squadinfratech@gmail.com)